

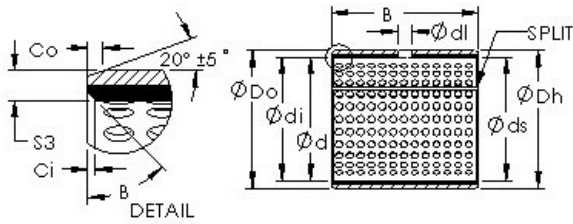

NTA PRECISION AXLE CORP.

AST AST20 28050 plain bearings



Bearing No. AST20 28050

Bore Diameter	280 mm
Outer Diameter	285 mm
Bearing Type	straight
Shaft Dia., Nominal (d)	280.0000
Shaft Size (ds) - 280 +0 / -0.081	280 +0 / 0.081
Housing Bore Dia. (Dh) - 285 +0.052 / -0	285 +0.052 / 0
Bearing Outside Diameter, Nominal(Do)	285.000
Bearing Outside Diameter Tolerance (Do tol.)	285.260 / 285.170
Bearing Bore after Mounting (di)	280.282 / 280.110
Average Clearance (Cd)	0.2320
Wall Thickness (S3)	2.418
Bearing Length, Nominal (B)	50.000
Bearing Length Tolerance (B tol.) - +0 / -0.40	+0 / 0.40
OD Chamfer Length (Co)	1.800
ID Chamfer Angle (B deg.)	45
ID Chamfer Length (Ci)	0.800
Lube Hole Dia. (dl)	9.500
Material	Carbon steel shell with POM plastic liner

AST20 28050 Bearing 2D drawings and 3D CAD models